

N/F AJ GUTIERREZ AND JA CATALDO, TRUSTEES  
MAP 56, PARCEL 19

S 10°11'30" E  
149.72

N/F BOSTON EDISON COMPANY  
MAP 56, PARCEL 16

163.70

PARKING REQUIREMENTS TABLE			
TOTAL SQUARE FEET OF FLOOR AREA	REQUIRED	EXISTING	PROPOSED
2100 (BURL VET CLINIC)	11 (BZL 7.2.5.4)		11
700 (CIGARS & MORE)	3 (BZL 7.2.5.8)		3
1400 (NAIL SALON)	8 (BZL 7.2.5.12)		10
	TOTALS	23	24

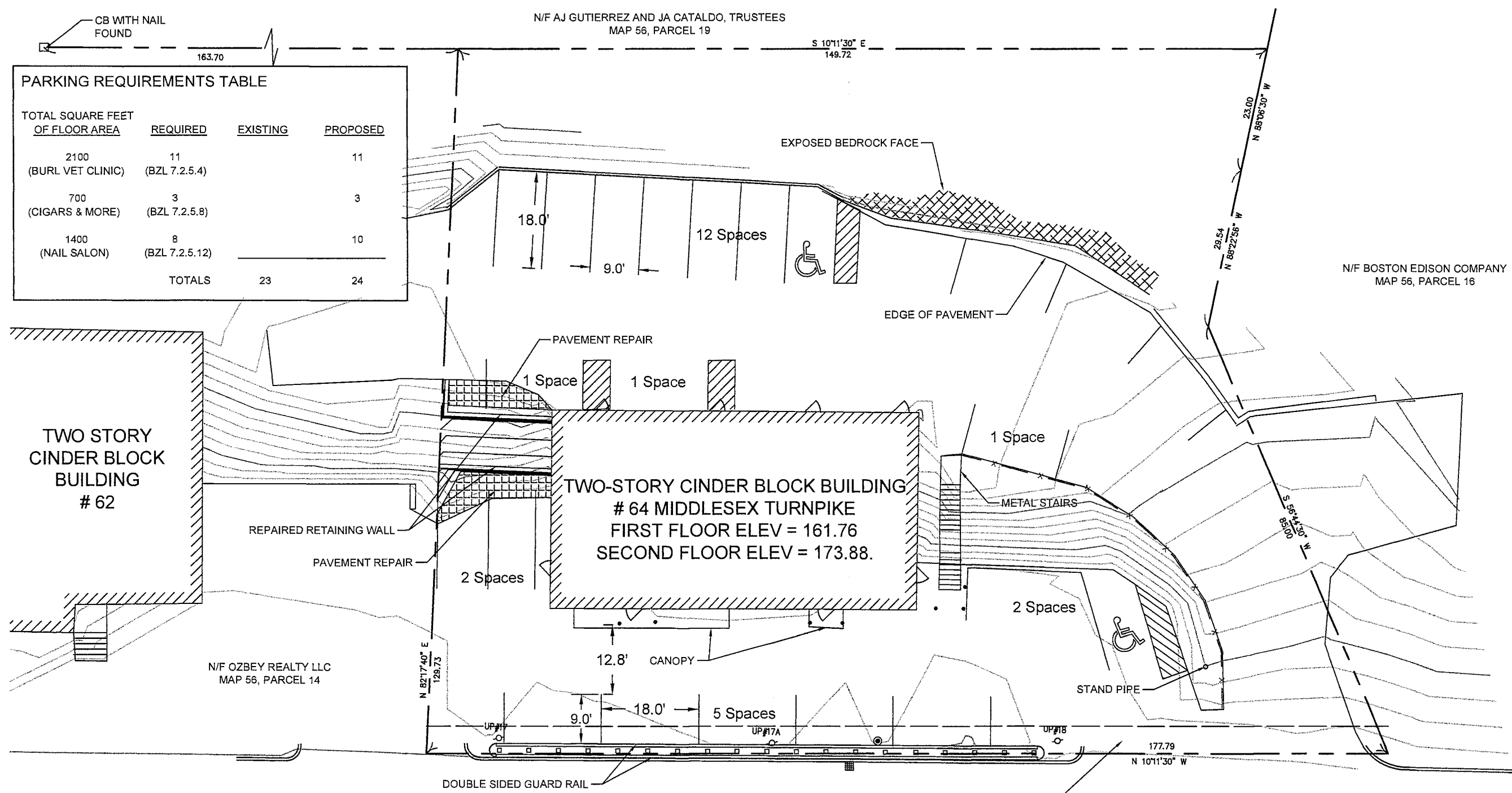

DECOULOS & COMPANY LLC  
185 ALEWIFE BROOK PARKWAY  
CAMBRIDGE, MA 02138  
DECOULOS.COM  
617.489.7795

PROPOSED SITE PLAN  
64 MIDDLESEX TURNPIKE  
BURLINGTON, MASSACHUSETTS

DATE  
OCT 24, 2018  
SCALE  
1" = 20'  
DRWN DD  
DES JJD  
CHKD JJD  
APRVD JJD

FIGURE  
1 OF 1

TWO STORY  
CINDER BLOCK  
BUILDING  
# 62

TWO-STORY CINDER BLOCK BUILDING  
# 64 MIDDLESEX TURNPIKE  
FIRST FLOOR ELEV = 161.76  
SECOND FLOOR ELEV = 173.88.

N/F OZBEY REALTY LLC  
MAP 56, PARCEL 14

5 FOOT PERMANENT EASEMENT HELD BY THE TOWN OF BURLINGTON  
"FOR THE PURPOSE OF CONSTRUCTING AND MAINTAINING THE AFORESAID HIGHWAYS  
AND CONSIST OF THE RIGHT TO ENTER UPON SAID LAND AT ANY TIME AND TO CONSTRUCT THEREON  
AND TO USE AND MAINTAIN HIGHWAYS, GUARDRAIL, TRAFFIC SIGNALS, TRAFFIC CONTROL ITEMS, AND UTILITIES."  
MA LAND COURT DOCUMENT NO. 687893 (PARCEL E-15)

MIDDLESEX TURNPIKE  
PUBLIC - VARIABLE WIDTH

REFERENCES

1. PLAN OF LAND IN BURLINGTON, MASSACHUSETTS; NOVEMBER 2, 1955; BY: NORTHEASTERN ENGINEERING ASSOCIATES; RECORDED AT THE MIDDLESEX REGISTRY OF DEEDS (THE "REGISTRY") AS PLAN NUMBER 2114 OF 1955.
2. PLAN SHOWING EASEMENTS AND RIGHT-OF-WAY OF MIDDLESEX TURNPIKE IN THE TOWN OF BURLINGTON, MIDDLESEX COUNTY; MAY 9, 1985; 13 SHEETS; BY: VANASSE HANGEN ENGINEERING, INC.; RECORDED AT THE REGISTRY AS PLAN NO 1099 OF 1985.
3. EASEMENT PLAN, BURLINGTON, MASSACHUSETTS; JULY 16, 2002; BY: HARRY R. FELDMAN, INC.; RECORDED AT THE REGISTRY AS PLAN NO 1218 OF 2002.
4. QUITCLAIM DEED OF ATBRENKA TRUST, LLC TO BURLEX REALTY, LLC DATED MARCH 2, 2018; RECORDED AT THE REGISTRY IN BOOK 66877, PAGE 408.
5. BURLINGTON ASSESSOR RECORDS, SEPTEMBER, 2018.
6. INSTRUMENT SURVEYS, SEPTEMBER, 2018.
7. ELEVATIONS REFERENCED TO NAVD88 WITH DUAL-FREQUENCY GPS STATIC SURVEY CORRECTED BY NGS OPUS ON SEPTEMBER 24, 2018.

LEGEND

- HYDRANT
- WATER GATE VALVE
- WATER LINE
- UP# UTILITY POLE
- TELEPHONE MANHOLE
- SEWER MANHOLE
- GAS LINE
- DRAIN MANHOLE
- CATCH BASIN
- 12" STORMWATER DRAIN LINE
- SOIL BORING
- GROUNDWATER MONITORING WELL
- △ STA POINT
- BOLLARD

