

Northwest Park

3

CONNECTOR ROAD TO 3RD AVE

NETWORK DRIVE

15

95

75

25  
PERMITTED  
LAND

35

45

65

55

AMENITY CENTER

FITNESS CENTER

SOUTH  
ENTRANCE

CENTER  
ENTRANCE

MIDDLESEX TURNPIKE

NETWORK DRIVE

NORTH  
ENTRANCE



Stonebridge  
at Burlington  
A STONEBRIDGE STAR LIVING COMMUNITY





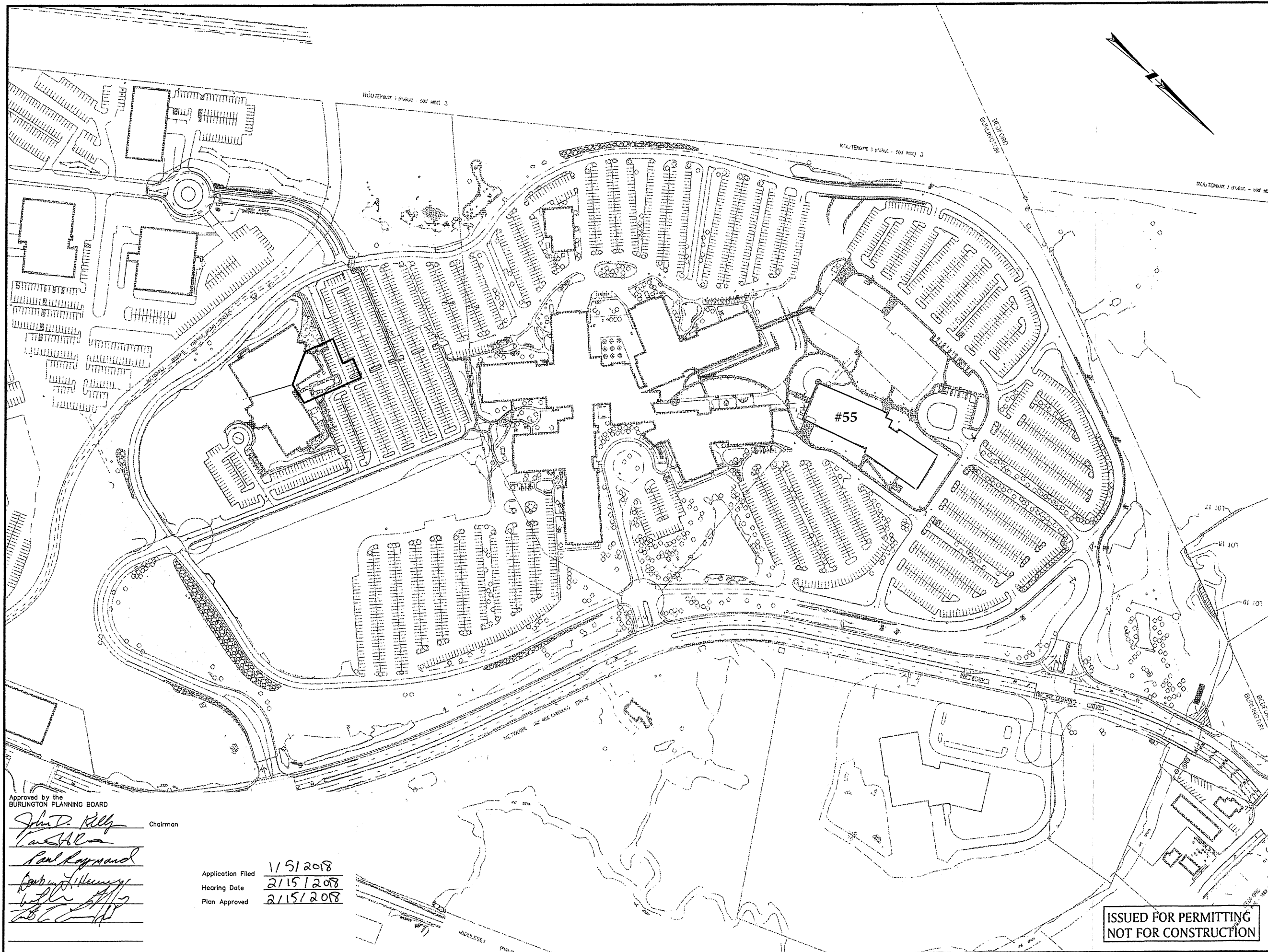

Approved by the  
BURLINGTON PLANNING BOARD

*John D. Kelly* Chairman  
*Paul Raymond*  
*John J. Kelly*  
*William J. Kelly*  
*John J. Kelly*

Application Filed 1/5/2018  
Hearing Date 2/15/2018  
Plan Approved 2/15/2018



PROFESSIONAL ENGINEER DATE

OVERVIEW PLAN  
MARCH 9, 2018

REVISIONS:

NO.	DATE	DESC.
1	3/2/18	PER MEC DECISION

PREPARED FOR:  
CA TECHNOLOGIES

PROPERTY OWNER:  
NORDBLOM COMPANY  
71 THIRD AVENUE  
BURLINGTON, MA 01803

**BSC GROUP**  
803 Summer Street  
Boston, Massachusetts  
02127  
617 896 4300

© 2018 The BSC Group, Inc.  
SCALE: 1" = 100'  
0 50 100 200 feet  
FILE: P:\2312606\PC\15 NWD\2312606-KEY  
DWG.: 2312606-KEY SHEET 1 OF 4  
JOB. NO: 2-3126.06

ISSUED FOR PERMITTING  
NOT FOR CONSTRUCTION

697D a