

FOR REGISTRY USE ONLY

PLAN REFERENCES

- 1. "ANR SUBDIVISION PLAN 200 AND 400 WHEELER ROAD BURLINGTON, MASSACHUSETTS PREPARED FOR THE GUTIERREZ COMPANY" PREPARED BY WSP SELL, INC. PLAN DATED MAY 5, 2010. RECORDED AT THE MIDDLESEX SOUTH REGISTRY OF DEEDS AS PLAN BOOK 378 OF 2010.

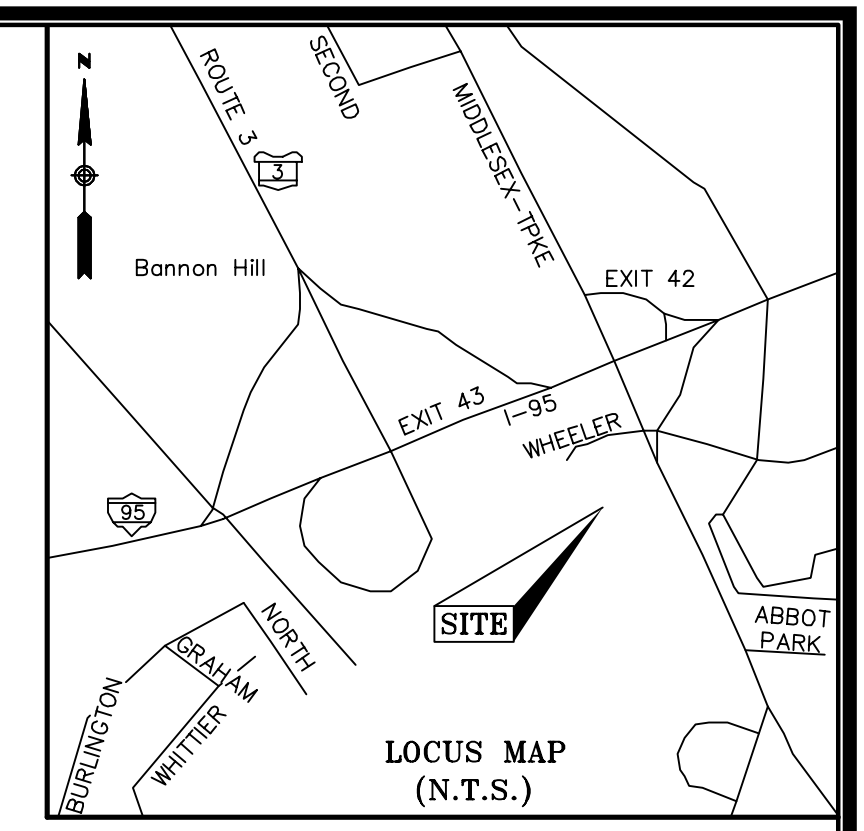

Parcel Line Table with columns for Line #, Length, and Direction. Lists lines L1 through L26 with their respective measurements.

PARCEL SUMMARY TABLE "LOT 400" showing original area and adjustments for parcels A through G.

PARCEL SUMMARY TABLE "LOT 600" showing original area and adjustments for parcels A through G.

NOTES

- 1. THIS PLAN WAS PREPARED FROM ACTUAL ON THE GROUND FIELD SURVEYS CONDUCTED BY WSP BEGINNING ON DECEMBER 13, 2006 TO MOST RECENT SURVEY DATE OF OCTOBER 2016.

LEGEND

- PROPERTY LINE (solid line)
FORMER PROPERTY LINE (dashed line)
ABUTTERS LINE (dotted line)
TOWN LINE (dash-dot line)

RECEIVED By Planning Department at 12:12 pm, Jan 17, 2017

BURLINGTON PLANNING BOARD

APPROVAL UNDER THE SUBDIVISION CONTROL LAW NOT REQUIRED DATE:

DATE:

GRAPHIC SCALE

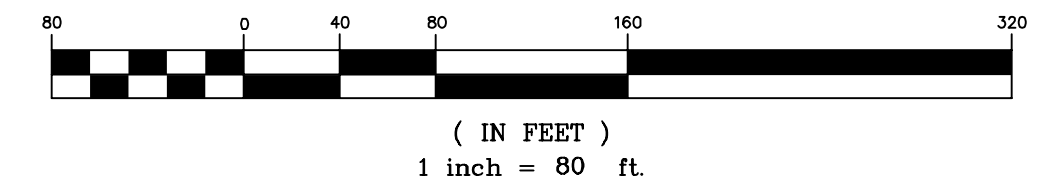

CERTIFICATION: I CERTIFY THAT THIS PLAN HAS BEEN PREPARED IN ACCORDANCE WITH THE RULES AND REGULATIONS FOR RECORDING AT THE REGISTRY OF DEEDS.

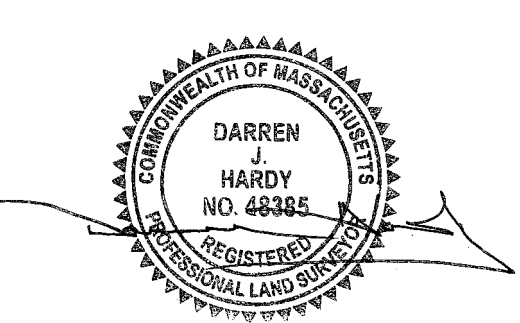

DARREN J. HARDY, P.L.S. 01/12/2017 REG. NO. 48385 WSP USA, CORP. 1530015-23-ANR.dwg

ANR SUBDIVISION PLAN 400 & 600 WHEELER ROAD BURLINGTON, MASSACHUSETTS PREPARED FOR THE GUTIERREZ COMPANY



155 Main Dunstable Rd. Suites 120 & 125 • Nashua, NH 03060 • 603.595.7900 www.wspells.com

Table with columns for Drawn By, Surveyed By, Checked By, Book No., Date, Scale, Job No., and Sheet No.

MIDDLESEX TURNPIKE (1962 STATE HIGHWAY LAYOUT) (PUBLIC - VARIABLE WIDTH)

MIDDLESEX TURNPIKE (1962 STATE HIGHWAY LAYOUT) (PUBLIC - VARIABLE WIDTH)